

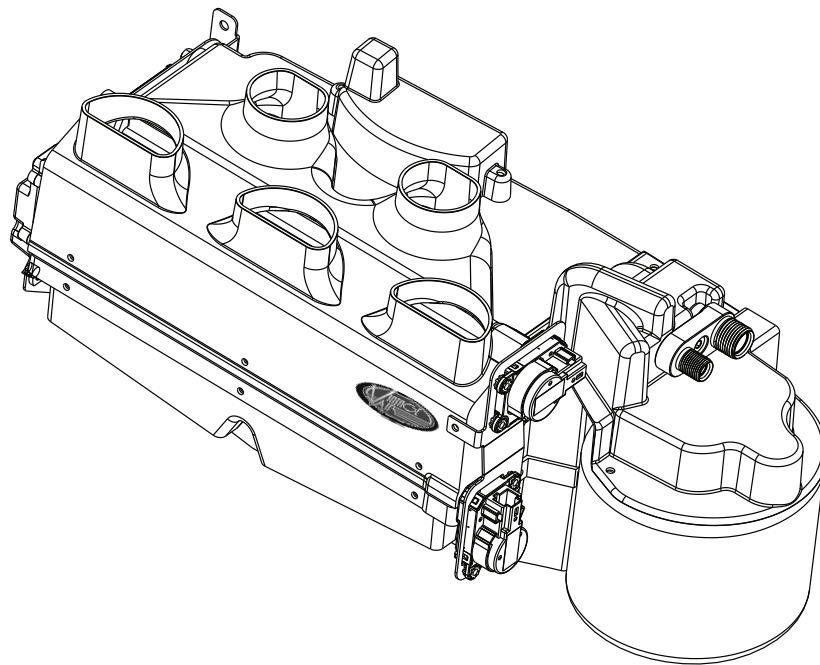

Gen 5 Compac

Mock-up Kit
(670002)



18865 Goll St. San Antonio, TX 78266
Phone: 800-862-6658
Sales: sales@vintageair.com
Tech Support: tech@vintageair.com
www.vintageair.com



www.vintageair.com

Table of Contents

Cover.....	1
Table of Contents.....	2
Packing List/Parts Disclaimer.....	3
Gen 5 Compac Mock-Up Overview, Gen 5 Compac Mock-Up Planning Checklist.....	4
Gen 5 Compac Mock-Up Installation.....	5
Gen 5 Compac Mock-Up Installation (Cont.), Drain Hose Installation.....	6
Packing List.....	7



www.vintageair.com

Packing List: Gen 5 Compac Mock-Up (670002)

No.	Qty.	Part No.	Description
1.	1	670001	Sub Case, Gen 5, Compac Mock-Up
2.	1	637101	Installation Kit
3.	2'	06200-VUE	Duct Hose, 2"
4.	3'	06250-VUE	Duct Hose, 2 1/2"

** Before beginning installation, open all packages and check contents of shipment. Please report any shortages directly to Vintage Air within 15 days. After 15 days, Vintage Air will not be responsible for missing or damaged items.

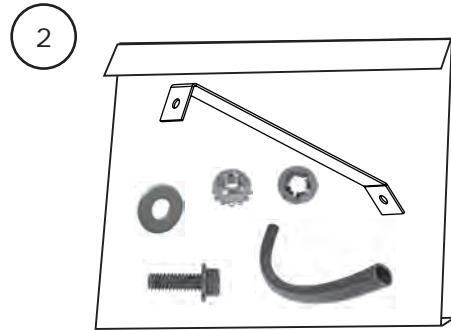
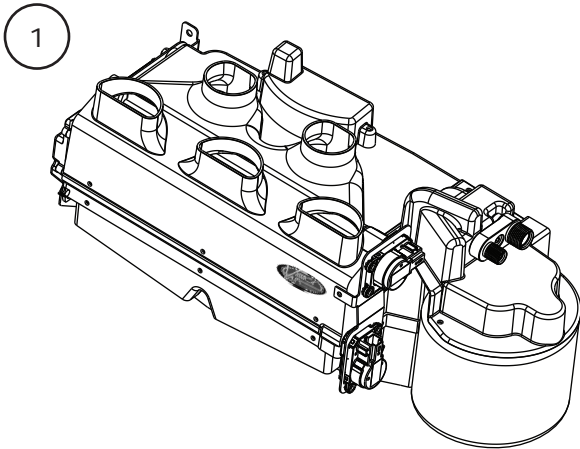

NOTE: Images may not depict actual parts and quantities.
Refer to packing list for actual parts and quantities.



www.vintageair.com

Gen 5 Compac Mock-Up Overview

The Gen 5 Compac Mock-Up Unit is designed to assist in planning and confirming the fitment of your system prior to installing the actual evaporator unit. This mock-up is a highly accurate, full-scale representation of the final product and allows installers to verify that the Gen 5 Compac will fit properly within the intended space. Many customers use the mock-up not only to confirm fitment, but also to fabricate mounting brackets, route refrigerant and heater hoses, plan electrical wiring, and lay out duct hose paths. This approach helps prevent damage to the actual unit during the fabrication and layout stages, ensuring a cleaner and more confident final installation.

Gen 5 Compac Mock-Up Planning Checklist

Use this checklist to guide your installation planning before drilling or fabricating any components. Confirm each item to ensure a smooth and accurate final install:

Fitment & Orientation:

- Ensure the unit fits in the intended location with adequate clearance
- Ensure the unit is level left-to-right and fore-aft **NOTE: Use a level on flat bottom surfaces**
- Ensure the drain fitting is at the bottom, and the duct outlets are pointing straight up
- Ensure the blower and refrigerant connections are oriented correctly for the application:
 - Blower/fittings to the right (typical)
 - Blower/fittings to the left (alternate for center mount or RHD vehicles)

Mounting & Structure:

- Ensure the mock-up is secured temporarily for test fitting
- Ensure no holes are drilled until the hoses, wires, and duct routing is confirmed
- The mounting brackets can be fabricated using the mock-up as a reference

Hose & Wiring Planning:

- Ensure the heater and refrigerant hoses are routed cleanly with:
 - Proper bend radius
 - Clearance for fittings
 - No sharp edges nearby
- Ensure the electrical wiring path is planned with service access in mind

Duct Hose Routing:

- Ensure the dash vent outlets ((3) large top ports) have the shortest, smoothest hose paths
- Ensure the defrost outlets ((2) smaller top ports) are routed upward, with minimal bends
- Ensure the floor outlets ((2) flat, downward ports) are positioned for optimal heat output
- Ensure all ducts are free of kinks, crush points, and abrupt turns

Additional Prep:

- Ensure the firewall, cowl, and floorboard insulation is completed before the final install
- Ensure any other under-dash work is completed while access is open



www.vintageair.com

Gen 5 Compac Mock-Up Installation

1. Brackets are furnished to mount the evaporator case. Attach to the firewall as shown in Figure 1, below.
2. The cowl vent handle will work if moved to the side. You can also convert to electric or cable operation. If you close off the cowl vent, the unit will fit higher in the car. **NOTE: To mount the unit higher, simply determine the new location, mark and re-drill the bracket to fit as described in Step 3 (See Figure 1, below). Be sure to allow sufficient clearance for routing the duct hoses.**
3. Install a 1 ft. section of provided duct hose to each of the 5 outlets (3x dash 2.5" hose, 2x defrost 2" hose). Avoid excessive crushing or kinking of the hose during installation steps that follow.
4. Have a helper hold the unit up as high as possible, with the blower housing against the passenger-side kick panel. Locate the bracket on the right side of the blower housing, with a hole above and below the blower. Scribe through the upper 1/4" hole in the bracket to mark the firewall. Check to see if the location you marked looks correct and will clear obstructions on both sides of the firewall. If so, drill a 9/32" hole in the firewall. Align the evaporator to the firewall by the upper hole of the blower motor bracket with a 1/4-20 x 3/4" bolt, pushnut, washer and nut as shown in Figure 2, below. Level the evaporator unit, then use the 1/4" hole in the evaporator driver-side bracket as a guide, to mark and drill a 9/32" hole in the firewall. Attach this bracket to the firewall with a 1/4-20 x 3/4" bolt. This will locate the evaporator horizontally. Drill (2) more holes in the firewall using the lower hole in both brackets to mark the centers.
5. A 1/4-20 x 3/4" serrated flange black bolt, 1/4" pushnut bolt retainer, 1/4" USS flat washer and 1/4-20 hex nut with star washer shown in Figure 2, below, on the lower left mounting ear of the evaporator will be repeated (4) times to secure the case through the 9/32" holes drilled through the firewall.
6. The (2) bolts factory installed through the slotted slide bracket to the driver-side case mounting bracket can be adjusted by the customer to the perfect fit of the case against the firewall. This slot gives the driver side of the case about 9/16" of fore/aft adjustment while the passenger-side mounting points remain fixed. This means that the case can pivot slightly about the (2) passenger-side bolts before all (4) bolts are tightened.
7. In conjunction with the (4) firewall mounting points, a single mounting point is provided for securing the evaporator to the dash. Secure the evaporator front bracket to the weld nut on the driver-side case bracket down low near the floor duct as shown in Figure 2, below. **NOTE: Use this evaporator front bracket as-is, modify it, or fabricate a custom dash bracket to fit properly.** The dash mounting bracket is secured to the case and dash using a 1/4-20 x 3/4" serrated flange black bolt, same as at the firewall.

Provides minimum clearance for BSC connector removal after unit installation

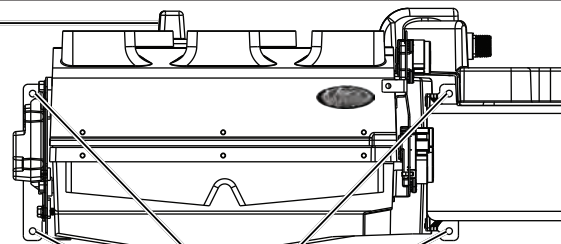

Figure 1

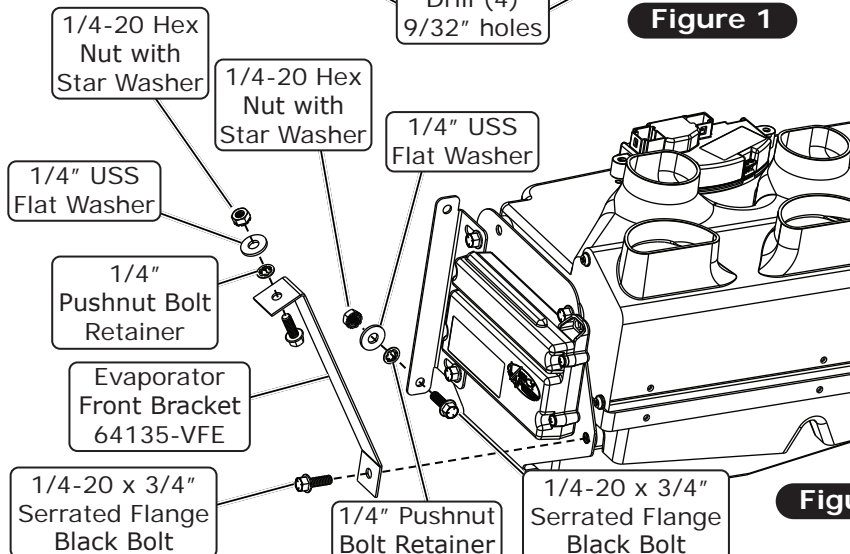

Figure 2



www.vintageair.com

Gen 5 Compac Mock-Up Installation (Cont.)

8. Because of a slight difference between the mock-up and production unit, keep the area around both blower screws clear of brackets and hoses (See Figures 3 and 4, below).

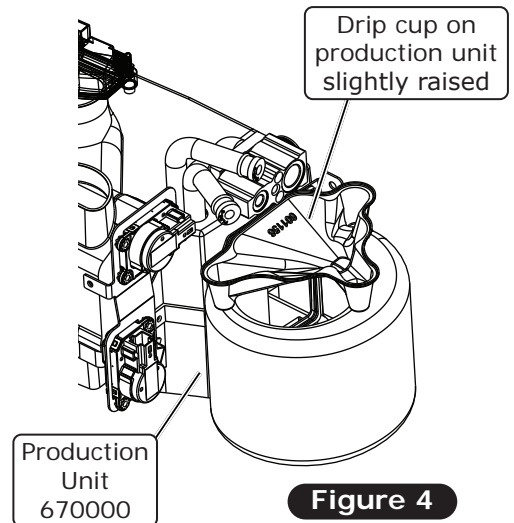
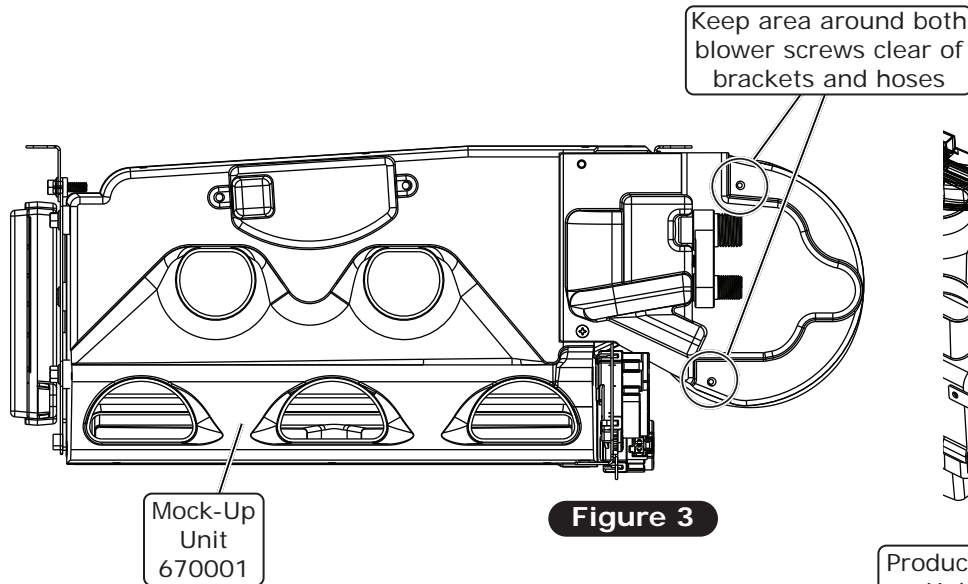

Drain Hose Installation

1. Drill a 5/8" hole through your preferred point of exit from the vehicle. Typical locations include the firewall, kick panel or floorboard. **NOTE: When determining drain location, consider the following: Drain hose must be installed with a minimum 1" drop from the drain nipple on the bottom of the evaporator case to the point where the drain hose exits the vehicle. Also, be sure to route the drain hose such that water drips directly onto the ground, rather than on any part of the vehicle frame.**
2. Install the drain hose onto the drain nipple on the sub case, then route the hose through the hole drilled in Step 1, above.

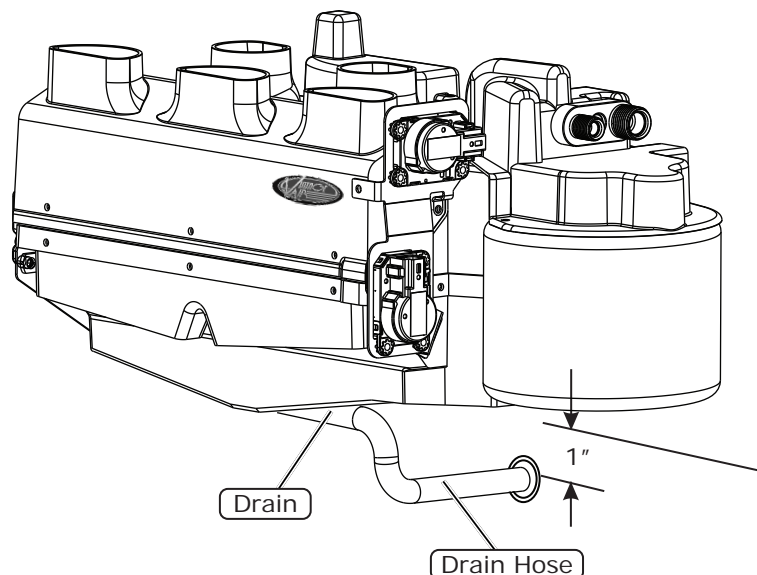



www.vintageair.com

Packing List: Gen 5 Compac Mock-Up (670002)

No.	Qty.	Part No.	Description
1.	1	670001	Sub Case, Gen 5, Compac Mock-Up
2.	1	637101	Installation Kit
3.	2'	06200-VUE	Duct Hose, 2"
4.	3'	06250-VUE	Duct Hose, 2 1/2"

Checked By: _____
Packed By: _____
Date: _____

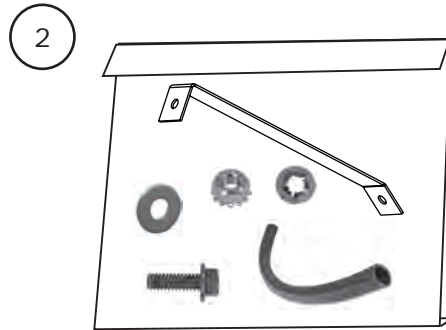
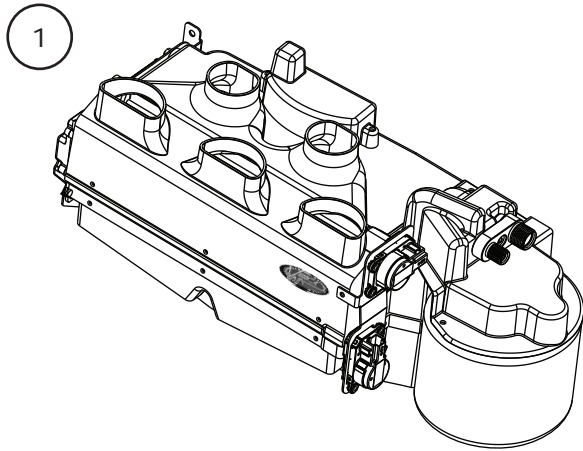

**NOTE: Images may not depict actual parts and quantities.
Refer to packing list for actual parts and quantities.**