

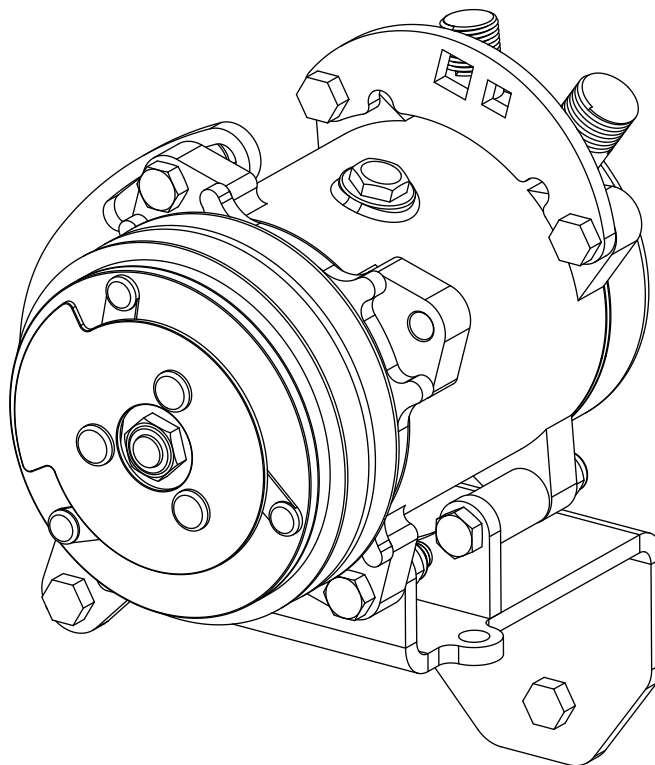

1965-76 Ford FE

Compressor Bracket Kit (137154)



18865 Goll St. San Antonio, TX 78266
Phone: 800-862-6658
Sales: sales@vintageair.com
Tech Support: tech@vintageair.com
www.vintageair.com



www.vintageair.com

Table of Contents

Cover.....	1
Table of Contents.....	2
Packing List/Parts Disclaimer.....	3
Bracket Installation.....	4-6
Belt Routing.....	7
Important Compressor Information.....	8
Packing List/Parts Disclaimer.....	9

Additional Info: Please Read Before Beginning

- This kit was designed for 1965-76 FE engines such as the 1965 Galaxie 390.
- This kit may be compatible with earlier or later applications but will be dependent on pulleys and accessories.
- This kit was designed for use with a 2-groove water pump pulley and 2-3 groove crank pulley.
- This kit was designed to work in conjunction with power steering kit (137159), (137021) or (137026) and Ford PS pulley such as 7AA, and Ford HBA style power steering pumps.



www.vintageair.com

Packing List: Compressor Bracket Kit (137154)

No.	Qty.	Part No.	Description
1.	1	137155	Compressor Bracket Assembly
2.	1	191154	Hardware Kit

**** Before beginning installation, open all packages and check contents of shipment. Please report any shortages directly to Vintage Air within 15 days. After 15 days, Vintage Air will not be responsible for missing or damaged items.**

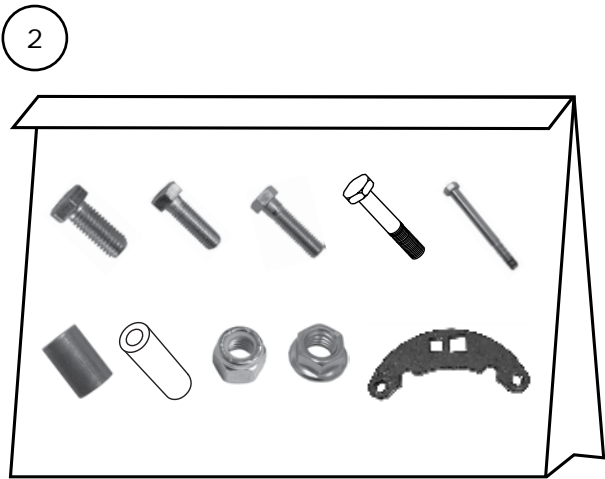
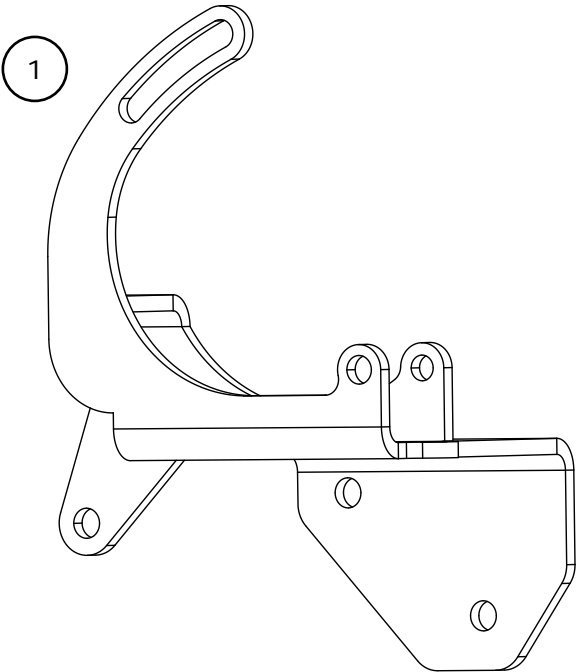

**NOTE: Images may not depict actual parts and quantities.
Refer to packing list for actual parts and quantities.**

NOTE: Before tightening bolts, assemble all brackets loosely to engine. This will ensure proper alignment of all brackets.

www.vintageair.com

Bracket Installation

1. Disconnect the battery.
2. Evacuate and remove the factory A/C compressor and bracket if equipped.
3. Install the compressor bracket onto the head using (2) 3/8-16 x 1" hex bolts (See Figure 1, below). Leave loose.
4. Using a thread-sealant, install a 3/8-16 x 3 3/4" hex bolt into the water pump using a 2.125" length spacer.
5. Tighten all (3) bolts.

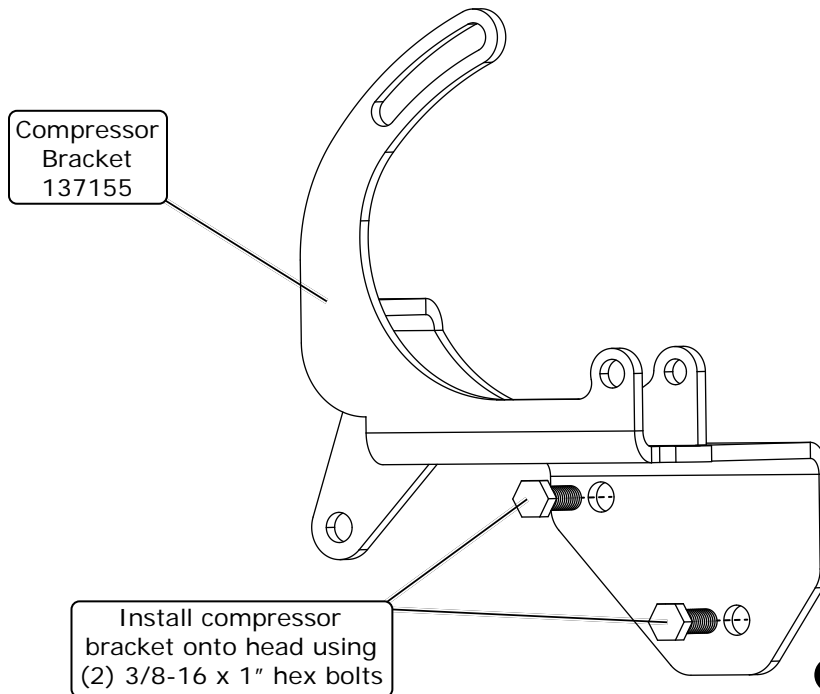

Figure 1

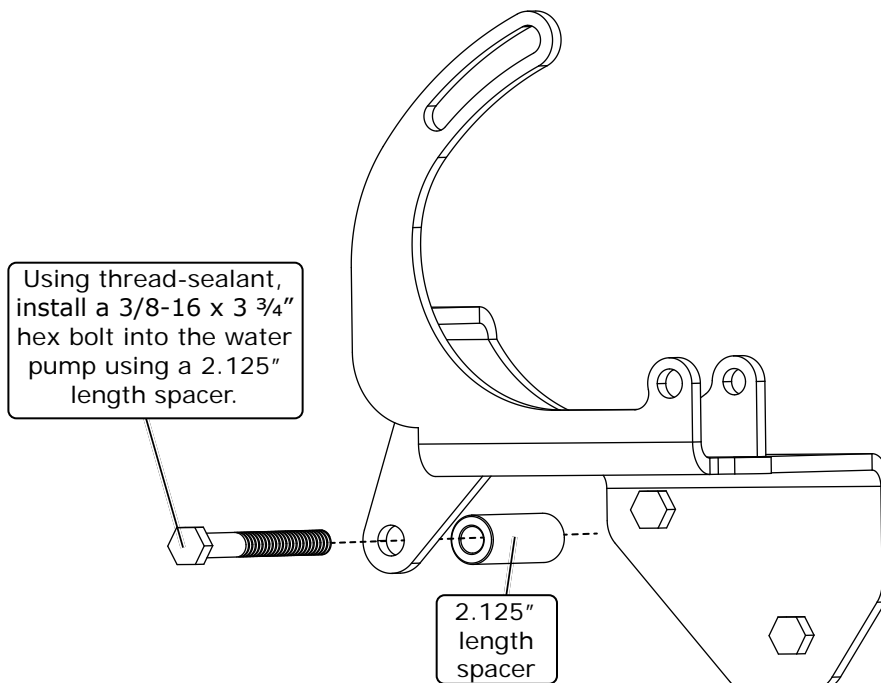

Figure 2

Bracket Installation (Cont.)

6. Place the compressor into the bracket cradle (See Figure 3, below).
7. Secure the front bottom-right ear of the compressor to the bracket using a 3/8-16 x 1 1/2" hex bolt and a 3/8-16 locknut (See Figure 3, below). Leave loose.
8. Secure the lower-right back ear of the compressor using a 3/8-16 x 2 1/2" hex bolt, a 1.125" length spacer, and a 3/8-16 locknut (See Figure 3, below). Leave loose.
9. Secure the upper-left ear of the compressor to the bracket using a 3/8-16 x 1 1/4" hex bolt and a 3/8-16 serrated flange hex nut (See Figure 3, below). Leave loose.

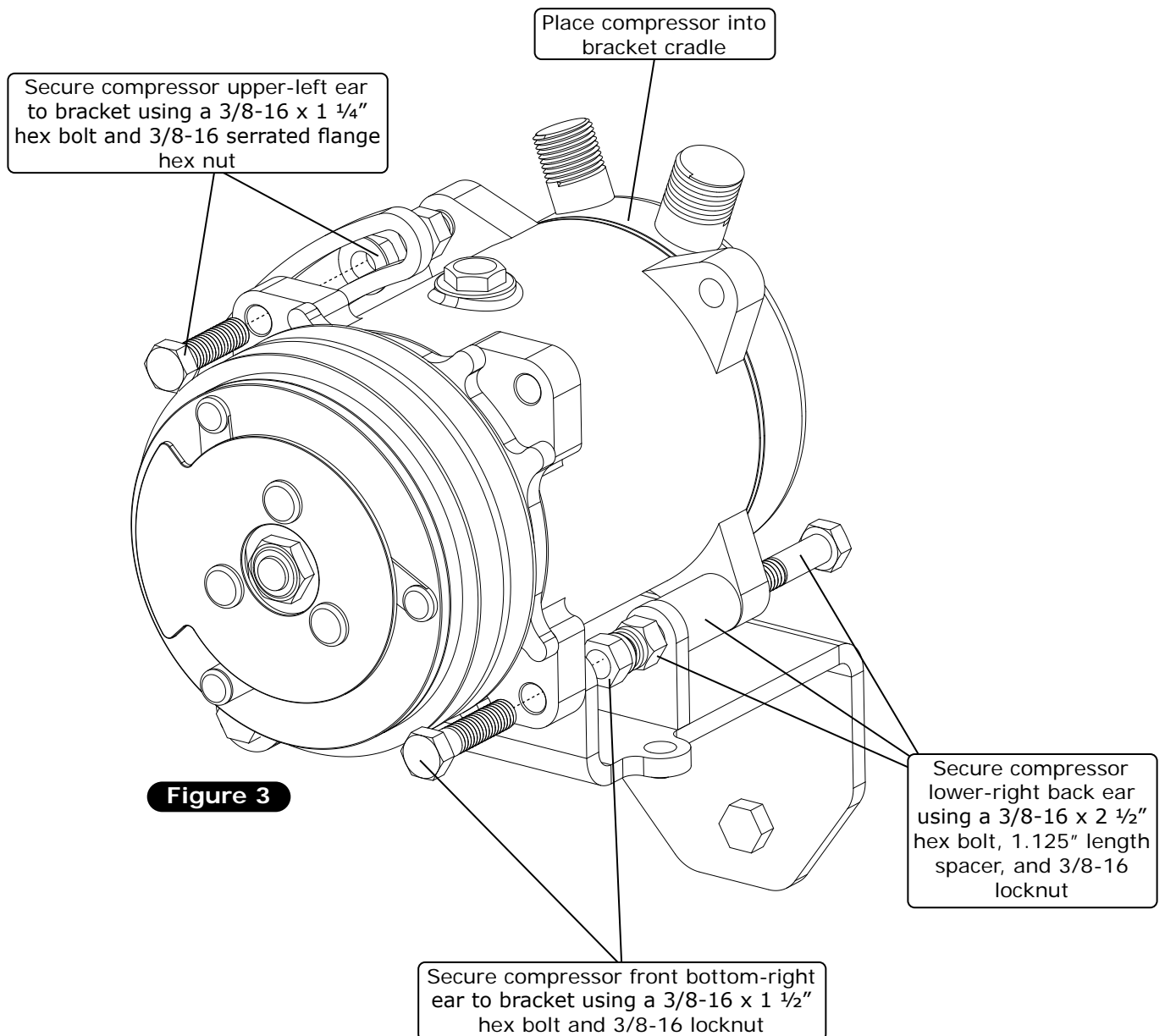

Figure 3

Bracket Installation (Final)

10. Install the correct sized V-belt and tension it using the compressor tensioning tool (See Figure 4, below).
11. Hold tension by tightening the upper hex bolt with a serrated flange hex nut (See Figure 4, below), then tighten lower hex bolts.

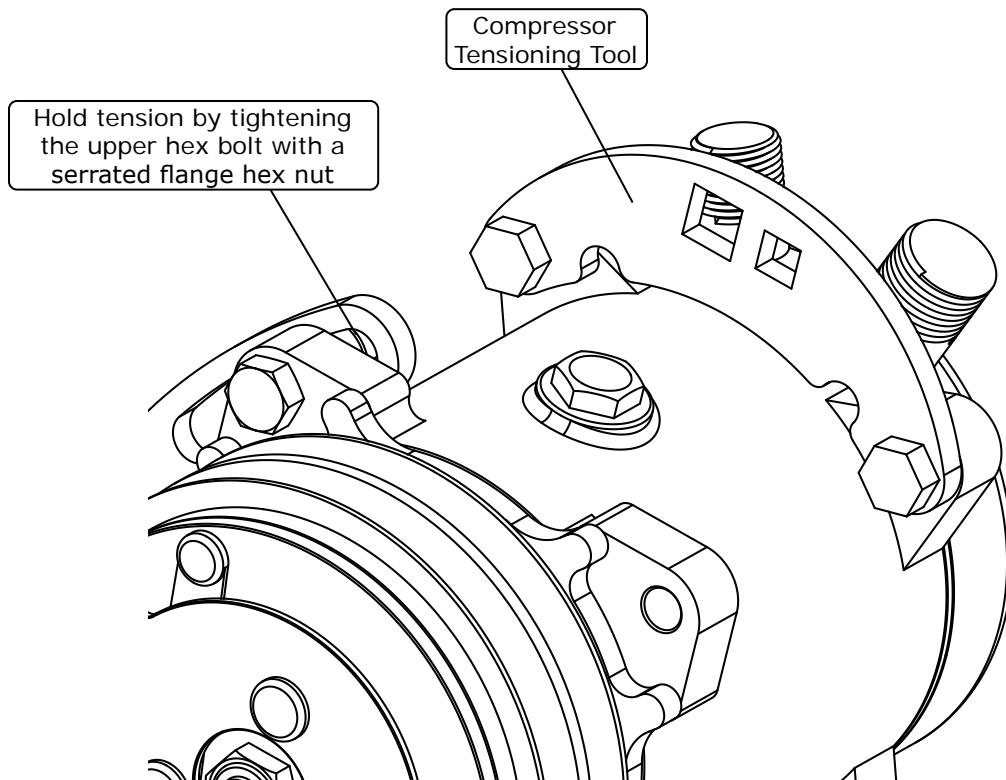
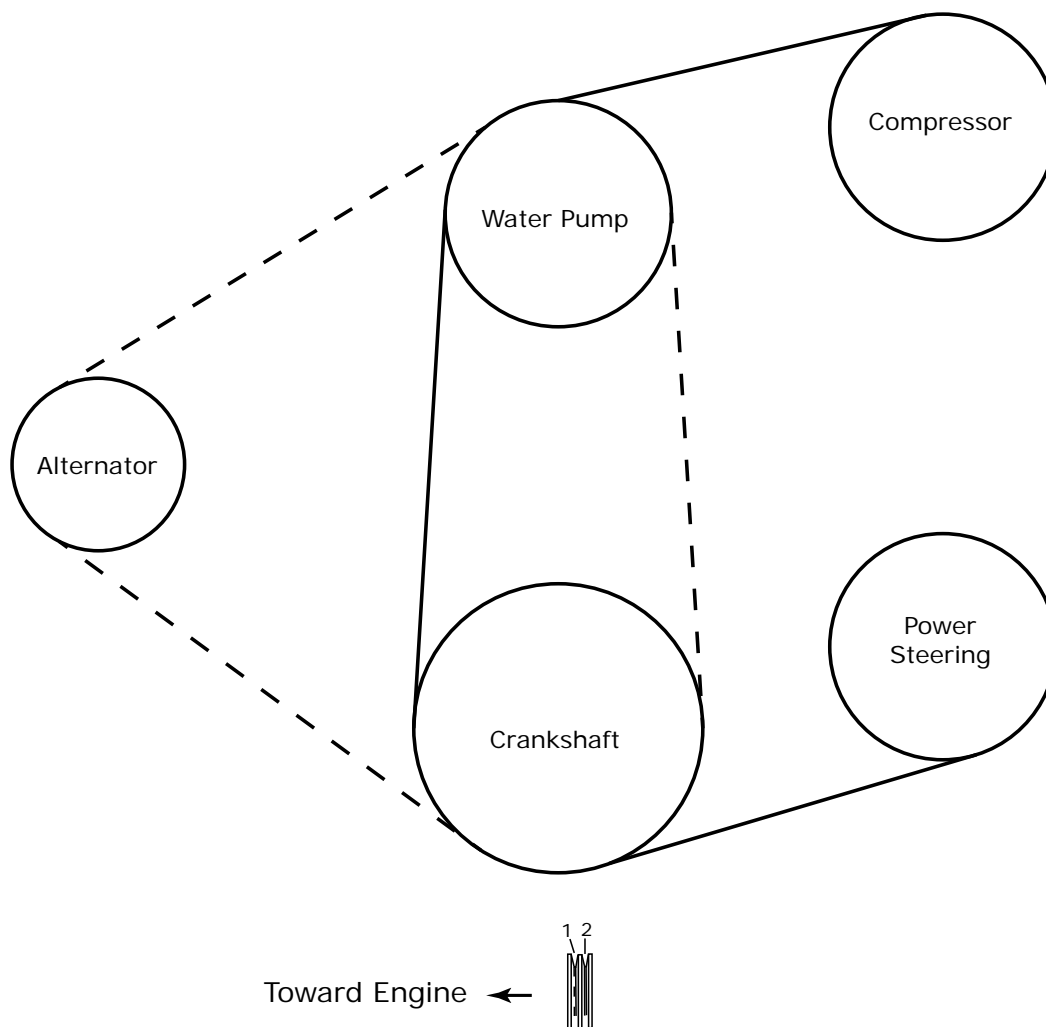

Figure 4

Belt Routing

1. Route belt as shown below. Vintage Air recommends using only Dayco, Gates or Goodyear brand reinforced V-belts with this compressor bracket kit.



Crankshaft Pulley Grooves:

1. Crankshaft, Water Pump & Alternator
2. Crankshaft, Water Pump, Compressor, Power Steering (Optional)

Important Compressor Information

Sanden 508 Style Compressors

NOTE: Failure to follow these procedures may void all warranties.

- Do not connect compressor clutch wire until system is being charged with refrigerant. Since an A/C system relies on refrigerant to circulate lubricant, running the compressor without refrigerant may destroy the compressor and void the warranty.
- Proper compressor orientation is important. Sanden compressors may be rotated from vertical (oil fill plug at top) up to 90° in either direction (See illustration, below).

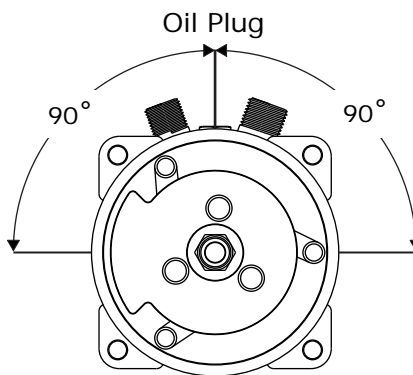

Sanden 7B10 Style Compressors

NOTE: Failure to follow these procedures may void all warranties.

- Do not connect compressor clutch wire until system is being charged with refrigerant. Since an A/C system relies on refrigerant to circulate lubricant, running the compressor without refrigerant may destroy the compressor and void the warranty.
- These compressors do not have an oil fill plug. Please reference the block fitting mount face for clocking range (See illustration, below).

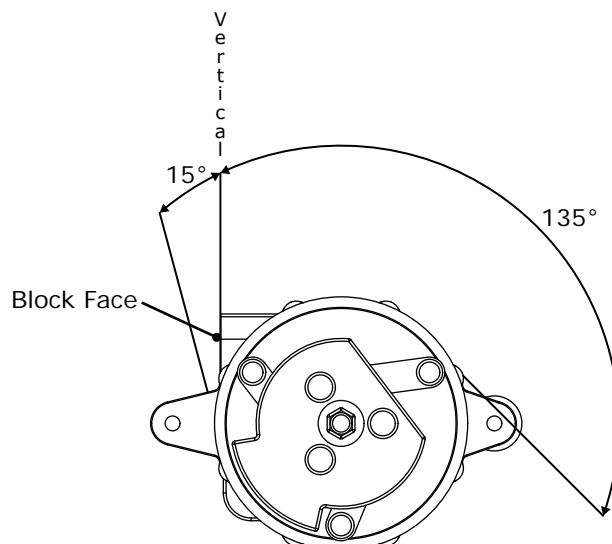



www.vintageair.com

Packing List: Compressor Bracket Kit (137154)

No.	Qty.	Part No.	Description
1.	1	137155	Compressor Bracket Assembly
2.	1	191154	Hardware Kit

Checked By: _____
Packed By: _____
Date: _____

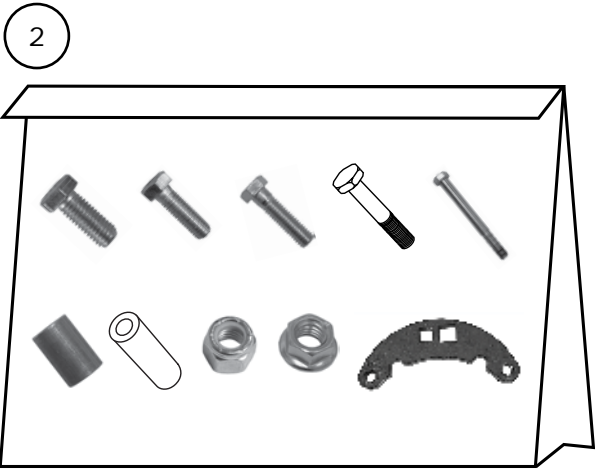
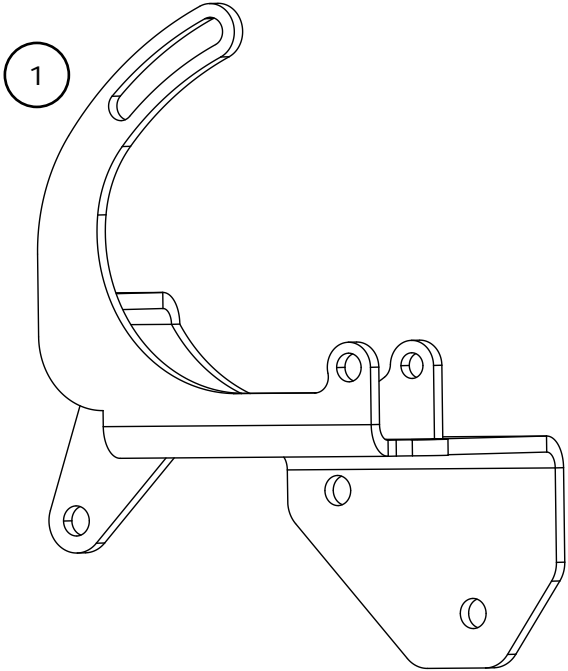

NOTE: Images may not depict actual parts and quantities.
Refer to packing list for actual parts and quantities.



www.vintageair.com

Packing List: 1965-76 Ford FE Compressor Hardware Bracket Kit (191154)

No.	Qty.	Part No.	Description
1.	4	18359-VUB	Bolt, 3/8-16 x 1", Hex
2.	1	18360-VUB	Bolt, 3/8-16 x 1 1/4", Hex
3.	1	18361-VUB	Bolt, 3/8-16 x 1 1/2", Hex
4.	1	18366-VUB	Bolt, 3/8-16 x 2 1/2", Hex
5.	1	18371-DSR	Bolt, 3/8-16 x 3 3/4", Hex
6.	1	18022-VUB	Spacer, .750" O.D. x .406" I.D. x 1.125" Length
7.	1	18221-VUB	Spacer, .750" O.D. x .406" I.D. x 2.125" Length
8.	2	18155-VUB	Locknut, 3/8-16
9.	1	181560	Nut, 3/8-16, Serrated Flange Hex
10.	1	646983	Compressor Tensioning Tool

Checked By: _____
Packed By: _____
Date: _____

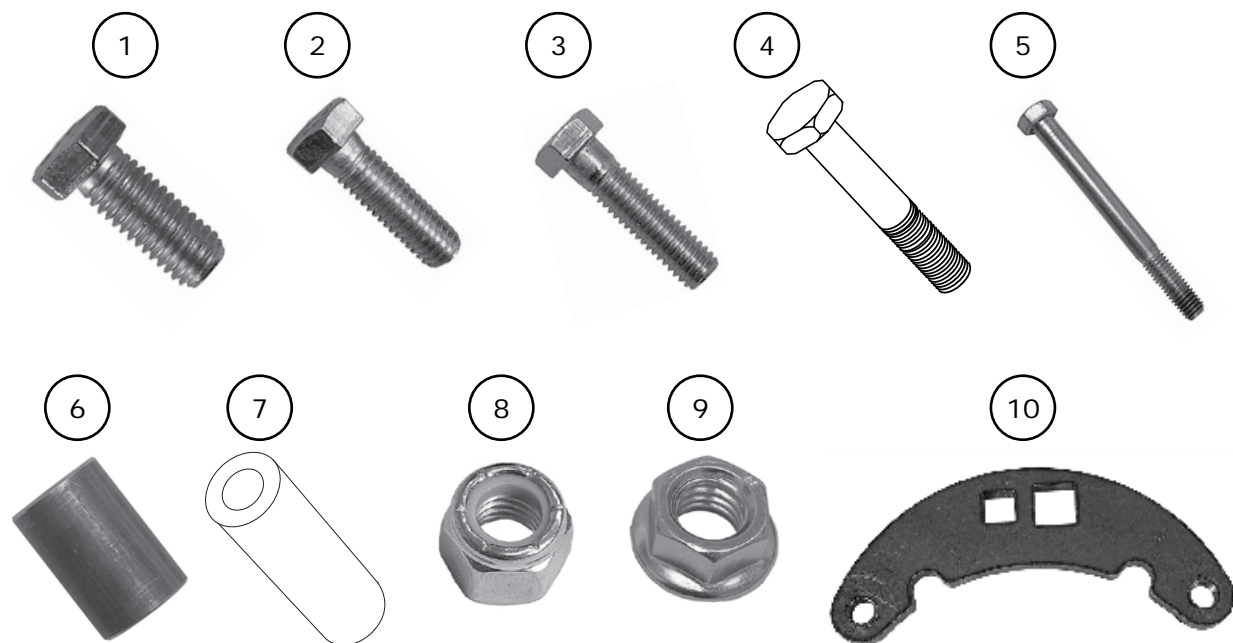

**NOTE: Images may not depict actual parts and quantities.
Refer to packing list for actual parts and quantities.**