

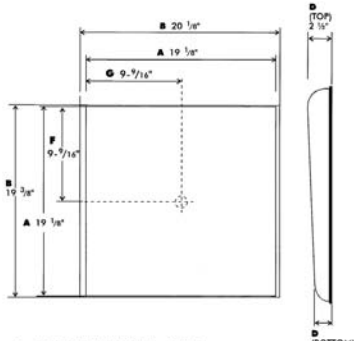

32042-VFF



- A - CORE DIMENSION (19 1/8" x 19 1/8")
- B - RADIATOR FLANGE DIMENSION (20 1/8" x 19 3/8")
- C - USERS DIMENSION
- D - DEPTH (2 1/2" - 1 3/4")
- E - BULGE (N/A)
- F - FAN OPENING LOCATION (HORIZONTAL) FROM TOPSIDE EOF CORE. (EXAMPLE ONLY MEASUREMENT - 9-9/16")
- G - FAN OPENING LOCATION (VERTICAL) FROM LEFT SIDE OF CORE - 9-9/16"

32042-VFF Fits:
 1942-51 Ford
 1946-48 Chevy
 1947-53 Chevy trucks
 1941-48 Plymouth
 1948 Dodge

1932 Ford Shroud

372032 Use with water pump riser 19212-VCB and 17" engine driven fan

372033 Designed for TCI chassis motor mount positioning (Fan hole is pre-cut as shown at left)

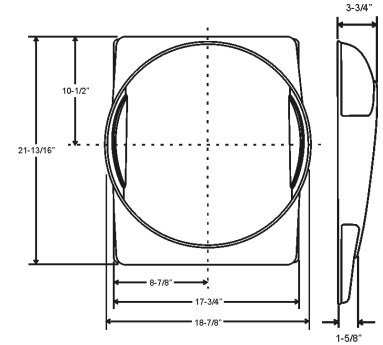

Universal 18" Shroud

37200-VUF For electric fan

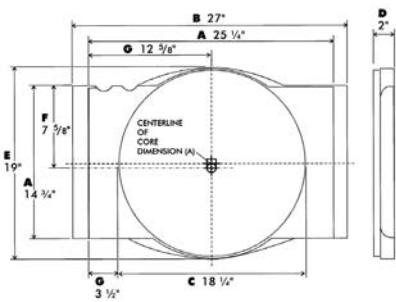

- A - CORE DIMENSION (14 1/2" x 25 1/2")
- B - RADIATOR FLANGE DIMENSION (14 1/2" x 27")
- C - FAN OPENING DIAMETER (18 1/2")
- D - DEPTH (2")
- E - BULGE (1 1/2")
- F - FAN OPENING LOCATION (VERTICAL) FROM TOP SIDE OF CORE
- G - FAN OPENING LOCATION FROM LEFT SIDE OF CORE (HORIZONTAL) - CENTERED

Universal 18" Shroud

37201-VUF For electric fan

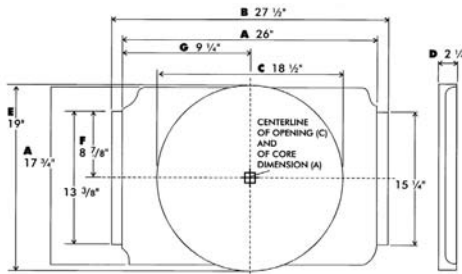

- A - CORE DIMENSION (17 1/2" x 26")
- B - FLANGE DIMENSION (17 1/2" x 27 1/2")
- C - FAN OPENING DIAMETER (18 1/2")
- D - DEPTH (2 1/4")
- E - BULGE - (1 1/2")
- F - OPENING LOCATION (VERTICAL) FROM TOP SIDE OF CORE - CENTERED
- G - OPENING LOCATION FROM LEFT SIDE OF CORE (HORIZONTAL) - CENTERED

Universal 18" Shroud

37202-VUF For electric fan

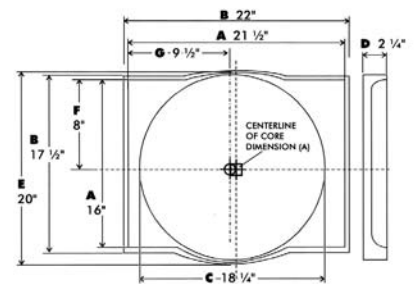

- A - CORE DIMENSION (16" x 21 1/2")
- B - RADIATOR FLANGE DIMENSION (17 1/2" x 22")
- C - FAN OPENING DIAMETER (18 1/2")
- D - DEPTH (2 1/4")
- E - BULGE (2 1/2")
- F - FAN OPENING LOCATION (VERTICAL) FROM TOP SIDE OF CORE - CENTERED
- G - FAN OPENING LOCATION FROM LEFT SIDE OF CORE (HORIZONTAL)

Universal 18" Shroud

37203-VUF For electric fan

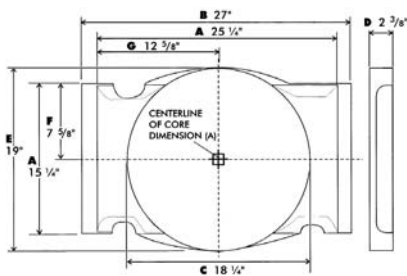

- A - CORE DIMENSION (15 1/2" x 25 1/2")
- B - RADIATOR FLANGE DIMENSION (15 1/2" x 27")
- C - FAN OPENING DIAMETER (18 1/2")
- D - DEPTH (2-3/8")
- E - BULGE
- F - FAN OPENING LOCATION (VERTICAL) FROM TOP SIDE OF CORE - CENTERED
- G - FAN OPENING LOCATION FROM LEFT SIDE OF CORE (HORIZONTAL) - CENTERED

Universal Shroud

37204-VUF For engine fan

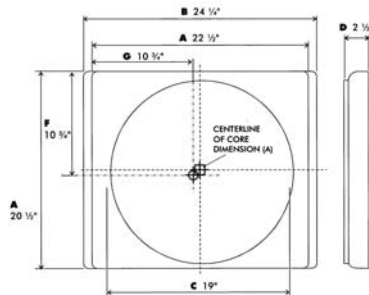

- A - CORE DIMENSION (20 1/2" x 22 1/2")
- B - FLANGE DIMENSION (20 1/2" x 24 1/2")
- C - FAN OPENING DIAMETER (19")
- D - DEPTH (2 1/2")
- E - BULGE (N/A)
- F - OPENING LOCATION (VERTICAL) FROM TOP SIDE OF CORE - OFFSET 1/2"
- G - OPENING LOCATION FROM LEFT SIDE OF CORE (HORIZONTAL) - OFFSET 1/2"

'69 Camaro/Universal Shroud

37269-VCF For electric fan

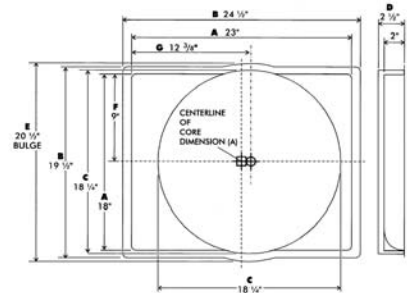

- A - CORE DIMENSION (18" x 23")
- B - RADIATOR FLANGE DIMENSION (19 1/2" x 24 1/2")
- C - FAN OPENING DIAMETER (18 1/2")
- D - DEPTH (2 1/2")
- E - BULGE (20 1/2")
- F - FAN OPENING LOCATION (VERTICAL) FROM TOP OF CORE (CENTERED)
- G - FAN OPENING LOCATION FROM LEFT SIDE OF CORE (HORIZONTAL)



TOTALLY COOLED GALLERY

We encountered this sleeper Camaro on the 2004 Hot Rod Power Tour. It features a full C-5 Corvette suspension, NASCAR cage, Baer brakes, LS1 and a Tremec 6 speed! Built by Paul McKee and his son Phillip for "Sunday drives", they naturally included a Vintage Air Gen-II system to tame the Arizona climate.